

Airbrushing With COPIC®



**Learn how to use the versatile
Copic Airbrush System on your next project**

The Copic System

- Alcohol Markers in 4 styles
- Easy-to-use Inks
- Rich, vibrant colors
- Smooth coloring & blending
- Refillable, replaceable tips
- Airbrushing
- Permanent on many surfaces
- Up to 322 colors
- Non-toxic, dries Acid-free*
- Won't dissolve toner on photo copies



A Lifetime of Coloring With Copic

Never before has there been the versatility of an alcohol ink combined with the easy application of a marker. These low-odor markers can be refilled over and over again. Some artists have had the same markers for over 20 years.

Airbrushing Embellishments

Copic ink blends smoothly, without damaging paper or streaking. For even coverage on unusual shapes, try airbrushing. Airbrushing is great for giving smooth color blends on a variety of surfaces: metal, ribbon, dried flowers, fabric, glass, leather, Easter eggs and more. Airbrushing gives beautiful backgrounds, subtle shading, and smooth transitions from color to color. Best of all, airbrushed ink sits on top of paper surfaces, using less ink than a marker touched directly to the paper.



Copic ABS 1

The convenient, portable Airbrushing System by Copic

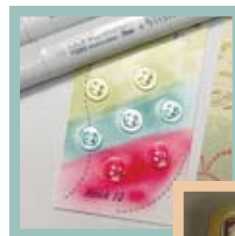

Airbrushed Buttons

Airbrushed Treat Tin

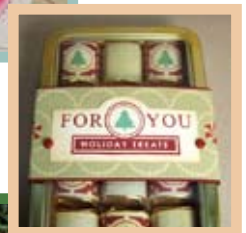

Papertrey

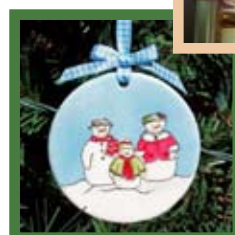

Airbrushed Ceramic Ornament



Airbrushing Basics

- Only Copic or Sketch Markers work with the Airbrush System (ABS).
- You can airbrush with either Copic aircans or hook your ABS up to a compressor.
- Copic Inks are transparent, so you can't airbrush over dark/black surfaces.
- The Copic ABS system blows air across the tip of the marker, spraying the dye suspended in alcohol onto your surface.
- The spray pattern adjusts by pushing harder or lighter on the trigger.
- You adjust the spray area by holding the air grip farther from the surface.

Airbrush Parts



Air Grip



Air Adaptor



Air Hose



Air Can Holder

Aircans

Note: The Aircan D60 holds less air because it has a built-in regulator that allows it to be used directly in the air grip. The other size aircans need an Air Adaptor to regulate the air pressure.



Air Can D60
7-8 min. of air



Air Can 80
20 min. of air



Air Can 180
45 min. of air

Which Airbrushing set should I get?

It depends on how you will be using it.

If you just want to try airbrushing before jumping into a larger system or you need a really portable system without much fuss, use the ABS-2. This gets you started with our smallest, most basic system. Uses Aircan D60.



If you want our complete, most cost-effective system without buying a compressor, then you should get the ABS-1. This lets you use our larger, more efficient Aircan 80 and Aircan 180. Includes an Air Grip, Air Adaptor, Airhose for aircans, Aircan 80, and holder.



If you already own a compressor, then use the ABS 3 set. Includes an air grip and air adaptor. You'll need to get an adapting bolt to match your air compressor to our 1/8" hose fitting (this is a standard Iwata or Sparmax hose size). Set the pressure between 40-60 psi.



COPIC Airbrush System Warning

- Use in an area with good air circulation.
- If using in an area of poor ventilation, use a facemask.
- COPIC Markers are alcohol based, keep away from open flame.
- Do not spray on people or animals.
- Air Cans are under pressure- do not puncture.



Setting Up the Airbrush Systems

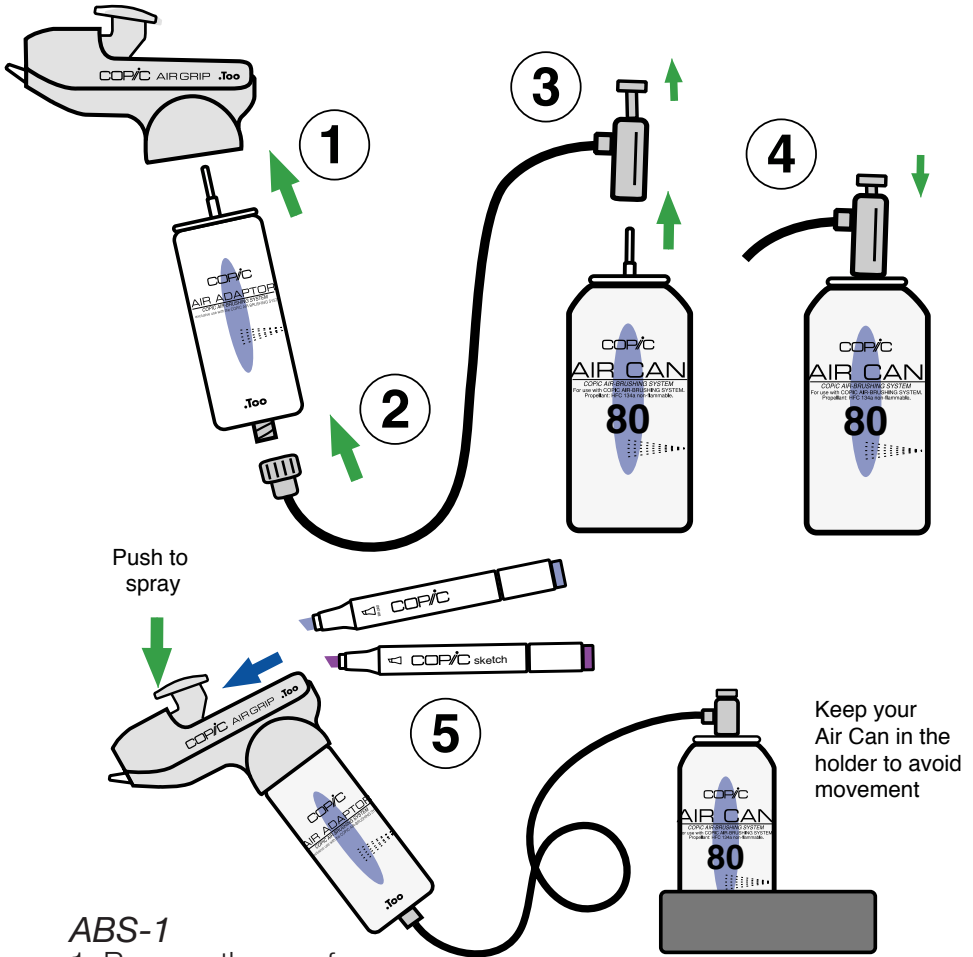

ABS-1

1. Remove the cap from the Air Adaptor and screw into the base of the Air Grip.
2. Attach the Air Hose to the base of the Air Adaptor.
3. Unscrew the top valve most of the way out. Attach the Air Can nozzle to the hose. You can use either the Aircan 80 or 180.
4. Screw the valve back in to activate Air Can. Note: When you are done using the Air Can, unscrew the top valve from the air hose before removing the Air Can.
5. Insert your favorite Copic Original or Copic Sketch marker into the Air Grip as shown with the broad nib pointing up. Aim straight down onto your surface then press finger pad to spray.

ABS-2 (not pictured)

1. Remove the cap from the Aircan D60 and screw into the base of the Air Grip.
2. Insert a Copic or Sketch marker into the Air Grip with the broad nib pointing up, then press finger pad to spray.

ABS-3 (not pictured)

Note: The airhose from the ABS 1 kit is for cans only, NOT compressors

1. Insert the Air Adaptor into the base of the Air Grip.
2. Attach the compressor Air Hose to the base of the Air Adaptor.
3. Insert a Copic or Sketch marker into the Air Grip with the broad nib pointing up, then press finger pad to spray.

Masking & Effects

The Copic Airbrush System is used primarily for making backgrounds or shading objects. The spray pattern is very soft and dispersed. If you need a crisp edge then you will need to mask any areas you do not want sprayed.

Test any adhesive you use for holding a mask in place. Some adhesives may tear your paper. Use a metal mask to easily hide edges, clean it with blender solution after each use.

Spray Patterns

- Color will be denser when you either press harder on the air grip or are close to the paper.
- Airbrush in small bursts to give the pen a chance to "recharge"
- The brush end of a Sketch marker will give you a larger speckle pattern.



Paper cut-out mask



Spellbinder's Nestability Rectangle Die used for mask

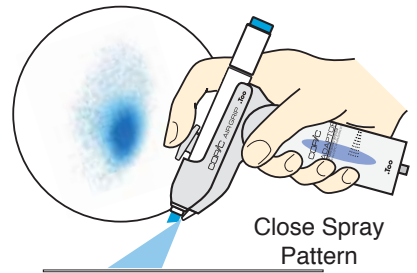

Close Spray Pattern

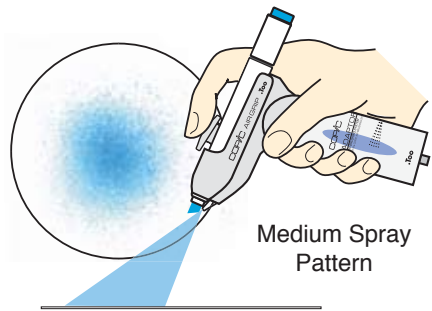

Medium Spray Pattern

Troubleshooting

Inconsistent Spray or Splattering

Uneven spray could be caused by a few things: First, check that all your fittings are nice and tight and that your Air Adaptor isn't punctured. If you are using air cans, check that the can hasn't tipped over, is empty, or that it isn't too cold. If you are using a compressor, make sure there is no moisture trapped in the line and that you are working with an air pressure between 40-60 psi.

Make sure that your marker is inserted correctly. If the marker is old, it may need refilling before you can airbrush evenly. Sketch markers will give a splattery look sometimes if you use the brush end as well.

Aircan gets cold

This is normal. If you are using the can for a long time and the spray gets inconsistent but it feels like there's still plenty of air in the can, then let your can warm up a bit before continuing. This is usually only a problem on the Aircan 80's.

No ink, but air is working

If the air is flowing correctly from the nozzle of the air grip, check these things:

- Make sure the marker is inserted correctly, with the chisel point up in the grip.
- If you are using Sketch markers check that the marker tip is straight up and down. Sometimes the med. Broad nib is not inserted all the way. Gently push on the marker tip to make sure the base of the tip is flush with the plastic edge of the marker body.
- If your marker is old or has been used a lot, it might need more ink.
- The fine point on a Copic Marker will not work, but either end works on a Sketch.
- If you are using a compressor, make sure the pressure is correct. Too little will not spray and too much will blow out the system.

Leaking air

Tighten all fixtures. Replace any worn hoses or fittings. If you are using your own compressor, make sure the fitting is the correct size. Sometimes when you first hook up a new system it will sound like it is leaking air. Just push the finger pad a few times to equalize pressure inside the fitting.

Which marker is best for Airbrushing?

All Copic markers contain the same ink, so the best marker is a personal choice. Below are the features that make Copic Original and Sketch markers different. Choose a type you like to get the effect you want.



Original Copic Marker

Great for airbrushing. Holds more ink to start with than the Sketch marker. Firm nibs are easy to write with. Square body design keeps it from rolling off your table. Gives one spray pattern. 214 colors, expandable to 322 with empty markers.



Copic Spray Pattern



Sketch Marker

Most popular marker for coloring. The flexible Brush nib is easy to blend with. Each end gives a different airbrushing effect. Holds slightly less ink than a Copic. Available in all 322 colors.



Sketch Broad Nib Spray Pattern



Sketch Super Brush Spray Pattern

Marker Features at a Glance

	COPIC	Sketch	Ciao	Wide
double ended	X	X	X	
refillable	X	X	X	X
replacement nibs	X	X	X	X
optional nibs	X	X	X	X
airbursh compatible	X	X		
empty markers	X	X		X
broad nib	X			
fine nib	X			
super brush nib		X	X	
medium broad nib		X	X	
21mm wide nib				X
dries acid free*	X	X	X	X
colors available	214	322	144	36

Whatever your marker needs, we've got you covered. Four different styles to choose from, all filled with our dynamic Copic alcohol inks.



For complete product information please visit

www.copicmarker.com

* On some papers a trace residue of alcohol may remain. See our website for more details.